

N.A.P.

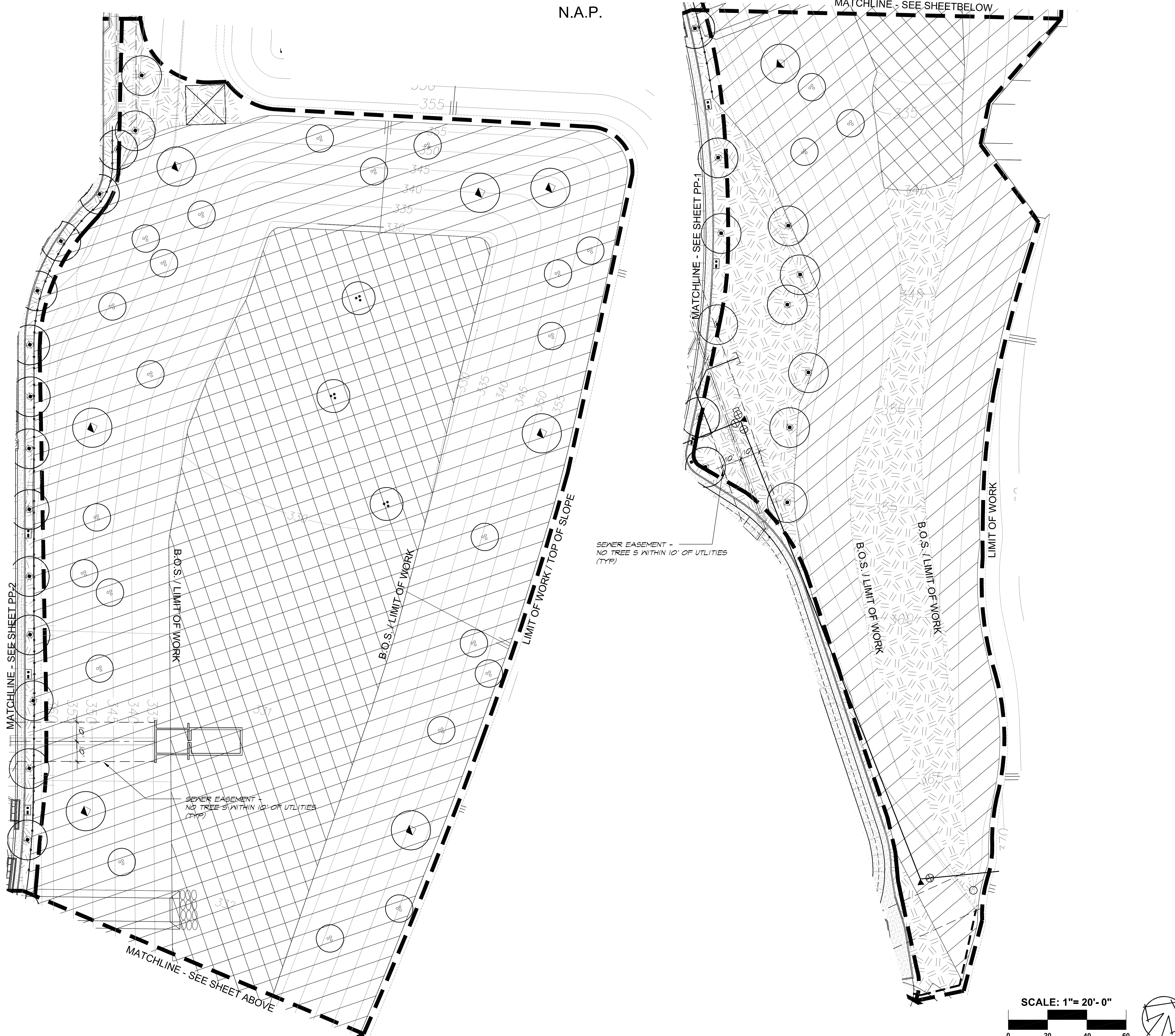

MATCHLINE - SEE SHEET BELOW

MATCHLINE - SEE SHEET PP-1

MATCHLINE - SEE SHEET PP-2

MATCHLINE - SEE SHEET ABOVE

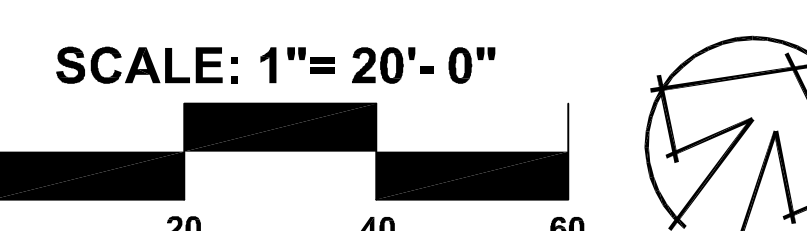

PLANT LEGEND

SLOPES

TREES

SYMBOL	BOTANICAL NAME / COMMON NAME	SIZE	QTY.	SPACING	DETAIL
☒	CUPANIA ANACARDIODES / CARROTWOOD	24" BOX	8	PER PLAN	3 / PD-1
⊗	PLATANUS ACERIFOLIA / LONDON PLANE TREE	24" BOX /	25	PER PLAN	3 / PD-1
⊗	PLATANUS RACEMOSA / CALIFORNIA SYCAMORE	24" BOX - MULTI-TRUNK	3	PER PLAN	3 / PD-1
⊗	SCHINUS MOLLE / CALIFORNIA PEPPER	24" BOX - MULTI-TRUNK	8	PER PLAN	3 / PD-1

☒ MARATHON SOD TURF FOR THE NON-SPORTS AREA OR APPROVED EQUAL

▨ UPLAND TRANSITION ZONE ON BASIN SLOPES (118,000 SF)

▨ RIPARIAN SCRUB ZONE ON BASIN FLAT AREA (44,000 SF)

HYDROSEED MIX - AVAILABLE FROM S&S SEEDS PH# (805) 684-0438

BOTANICAL/COMMON NAME	LBS / ACRE	QUANTITY MIX T.B.D. BY 545 SEEDS
AGROSTIS PALLENS/ LEAFY BENTGRASS	*	*
BACCHARIS PILULARIS COYOTE BUSH	*	*
BACCHARIS SALICIFOLIA MULEFAT	*	*
ENCELIA CALIFORNICA CALIFORNIA FUCHSIA	*	*
ESCHSCHOLZIA CALIFORNICA CALIFORNIA POPPY	*	*
IBOCOMA MENZIESII COASTAL GOLDENBUSH	*	*
LASTHENIA CALIFORNICA COASTAL GOLDFIELDS	*	*
LEYMUS CONDENSATUS GIANT WILD RYE	*	*
LUPINUS BICOLOR MINIATURE LUPINE	*	*
LUPINUS SUCCULENTUS ARROYO LUPINE	*	*
MIMULUS AURANTIACUS ORANGE BUSH MONKEYFLOWER	*	*
MIRABILIS CALIFORNICA CALIFORNIA WISHBONE BUSH	*	*
MUHLENBERGIA MICROSPERMA LITTLESEED MILLY	*	*
MUHLENBERGIA RIGENS CALIFORNIA DEERGRASS	*	*

HYDROSEED MIX (CONT) - AVAILABLE FROM S&S SEEDS PH# (805) 684-0438

BOTANICAL/COMMON NAME	LBS / ACRE	QUANTITY MIX T.B.D. BY 545 SEEDS
NASSELLA LEPIDA FOOTHILL NEEDLEGRASS	*	*
NASSELLA FULCHRA PURPLE NEEDLEGRASS	*	*
PENSTEMON SPECTABILIS VAR. ROYAL PENSTEMON	*	*
PLANTAGO ERECTA CALIFORNIA PLANTAIN	*	*
PLANTAGO OVATA WOOLLY PLANTAIN	*	*
POA SECUNDA SSP. SECUNDA MALFAIS BLUEGRASS	*	*
RIBES SPECIOSUM FUCHSIA-FLOWERED GOOSEBERRY	*	*
ROSA CALIFORNICA CALIFORNIA ROSE	*	*
VULPIA MICROSTACHYS PACIFIC FESCUE	*	*

CONTAINER PLANTS - AVAILABLE FROM TREE OF LIFE PH# (949) 728-0685

BOTANICAL/COMMON NAME	SIZE	QTY.
QUERCUS AGRIFOLIA COAST LIVE OAK	1 GAL	30
PLATANUS RACEMOSA WESTERN SYCAMORE	1 GAL	30
RUBUS URSINUS CALIFORNIA BLACKBERRY	1 GAL	30
SAMBUCUS MEXICANA MEXICAN ELDERBERRY	1 GAL	35

HYDROSEED MIX - AVAILABLE FROM S&S SEEDS PH# (805) 684-0438

BOTANICAL/COMMON NAME	LBS / ACRE	QUANTITY MIX T.B.D. BY 545 SEEDS
BACCHARIS EMORYI/ EMORY BACCHARIS	*	*
BACCHARIS PILULARIS COYOTE BUSH	*	*
BACCHARIS SALICIFOLIA MULEFAT	*	*
EPILOBIUM CANUM SPP. CANUM CALIFORNIA FUCHSIA	*	*
ERIOPHYLLUM CONFERTIFLORUM GOLDEN-YARRON	*	*
ESCHSCHOLZIA CALIFORNICA CALIFORNIA POPPY	*	*
JUNCUS ACUTUS SOUTHWESTERN SPINY RUSH	*	*
LASTHENIA CALIFORNICA COASTAL GOLDFIELDS	*	*
LEYMUS CONDENSATUS GIANT WILD RYE	*	*
LEYMUS TRITICOIDES BEARDLESS WILD-RYE	*	*
MIMULUS AURANTIACUS ORANGE BUSH MONKEYFLOWER	*	*
MIMULUS GUTTATUS SEEP MONKEYFLOWER	*	*
PLANTAGO ERECTA CALIFORNIA PLANTAIN	*	*

HYDROSEED MIX (CONT) - AVAILABLE FROM S&S SEEDS PH# (805) 684-0438

BOTANICAL/COMMON NAME	LBS / ACRE	QUANTITY MIX T.B.D. BY 545 SEEDS
PLANTAGO OVATA WOOLLY PLANTAIN	*	*
RIBES SPECIOSUM FUCHSIA-FLOWERED GOOSEBERRY	*	*
ROSA CALIFORNICA CALIFORNIA ROSE	*	*
RUBUS URSINUS CALIFORNIA BLACKBERRY	*	*
SOLANUM DOUGLASII DOUGLAS' NIGHTSHADE	*	*
VULPIA MICROSTACHYS PACIFIC FESCUE	*	*

CONTAINER PLANTS - AVAILABLE FROM TREE OF LIFE PH# (949) 728-0685

BOTANICAL/COMMON NAME	SIZE	QTY.
PLATANUS RACEMOSA WESTERN SYCAMORE	1 GAL	20
POPULUS FREMONTII WESTERN COTTONWOOD	1 GAL	20
RUBUS URSINUS CALIFORNIA BLACKBERRY	1 GAL	25
SALIX SPP. WILLOWS	1 GAL	20
SAMBUCUS MEXICANA MEXICAN ELDERBERRY	1 GAL	25

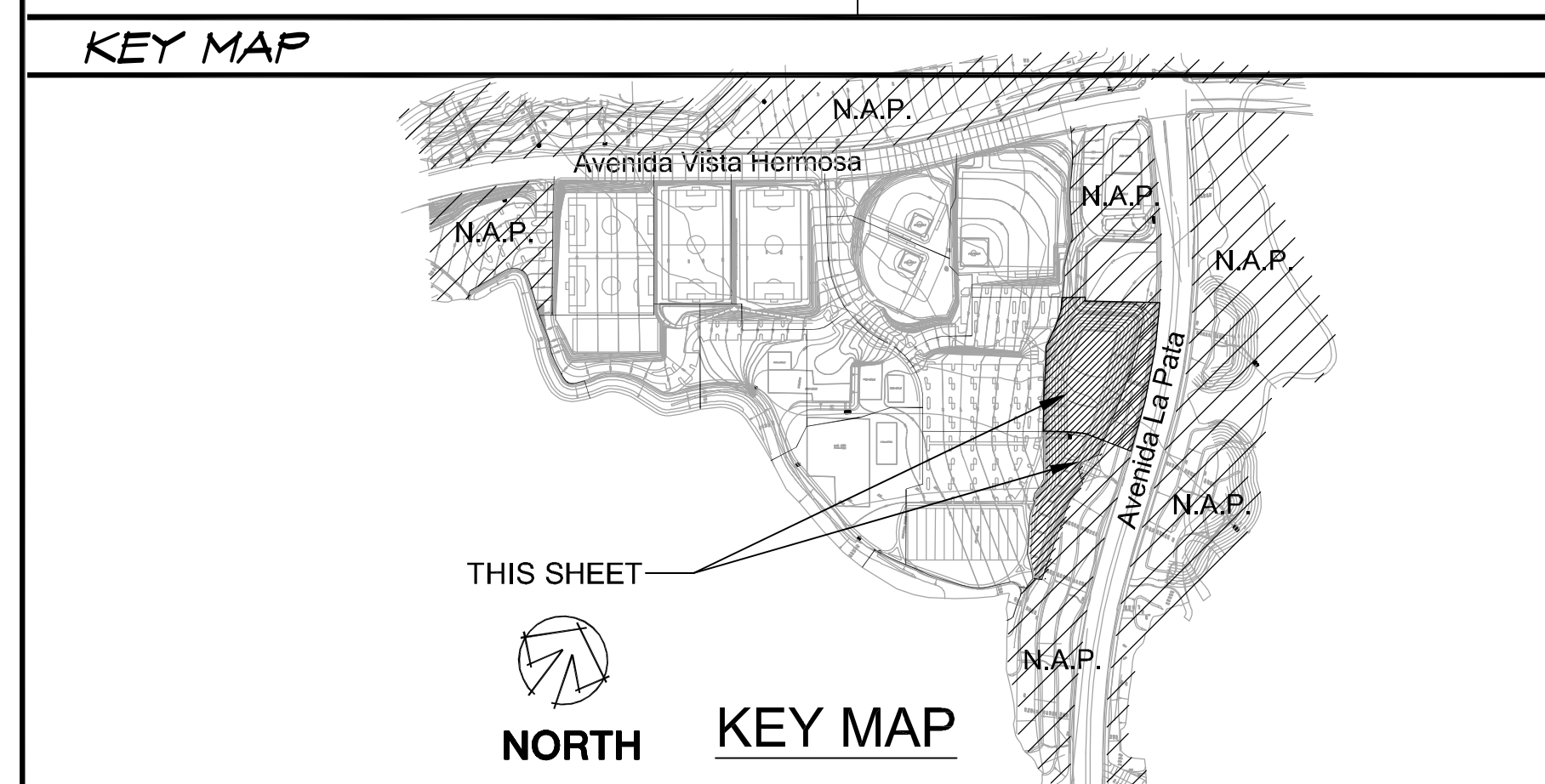

APPROVED BY:
AL KING, DIRECTOR OF BEACHES, PARKS, & RECREATION

REVISIONS			
NO.	DESCRIPTION	REVISED	APPROVED

JOB NO.: 100467
SMP NO.: 649-560
SCALE: AS SHOWN
DESIGNED BY: SMP

PLANS PREPARED BY:
SMP
PREPARED UNDER THE SUPERVISION OF:
PATRICK MURPHY

CITY OF SAN CLEMENTE
DEPARTMENT OF BEACHES, PARKS, & RECREATION
LA PATA PARK
PLANTING PLAN (SLOPES)

DRAWING NO.: PP-14
SHEET NO.: 99
OF 178

BID SET