

RETAINING WALL PROFILE

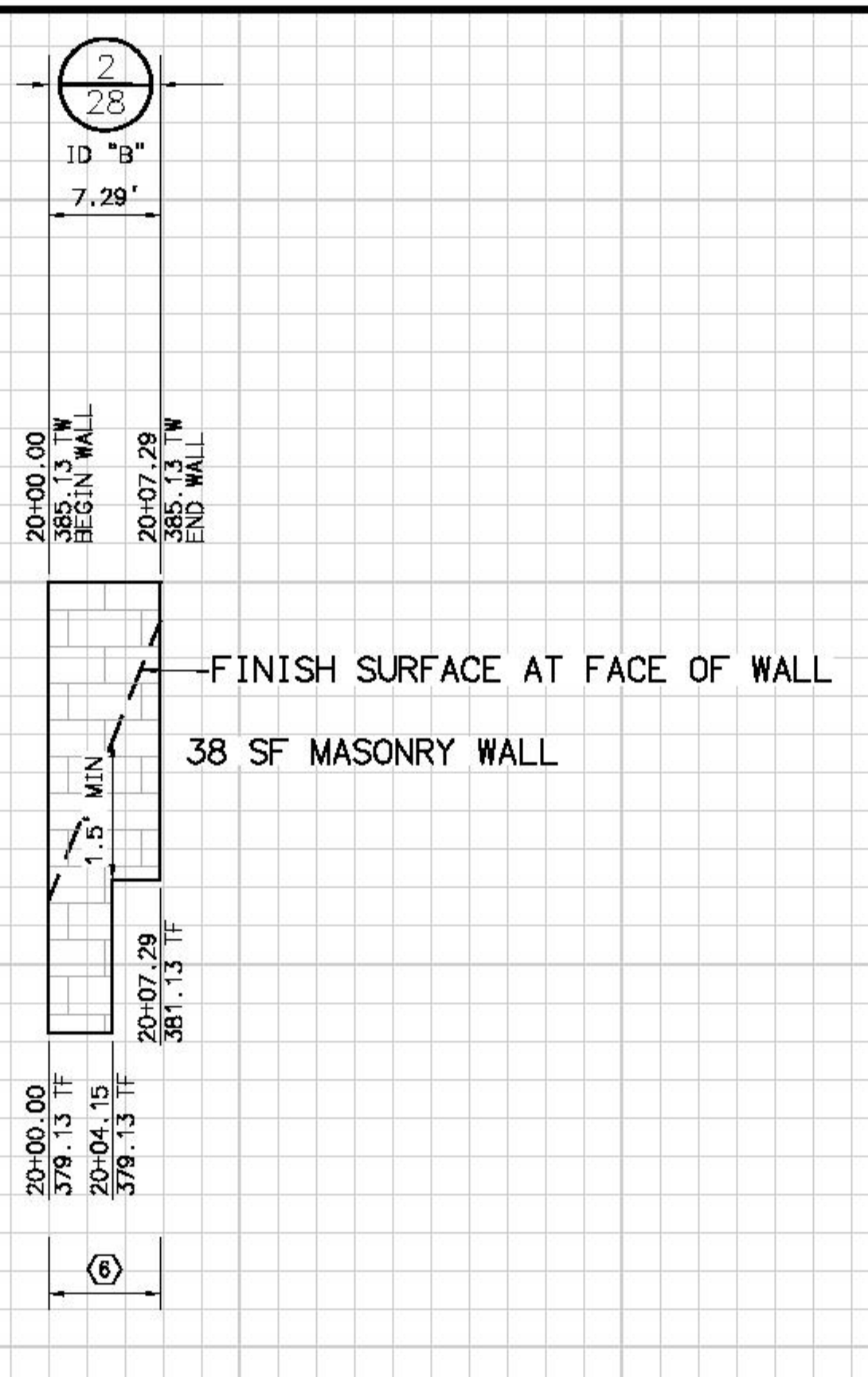

RETAINING WALL PROFILE

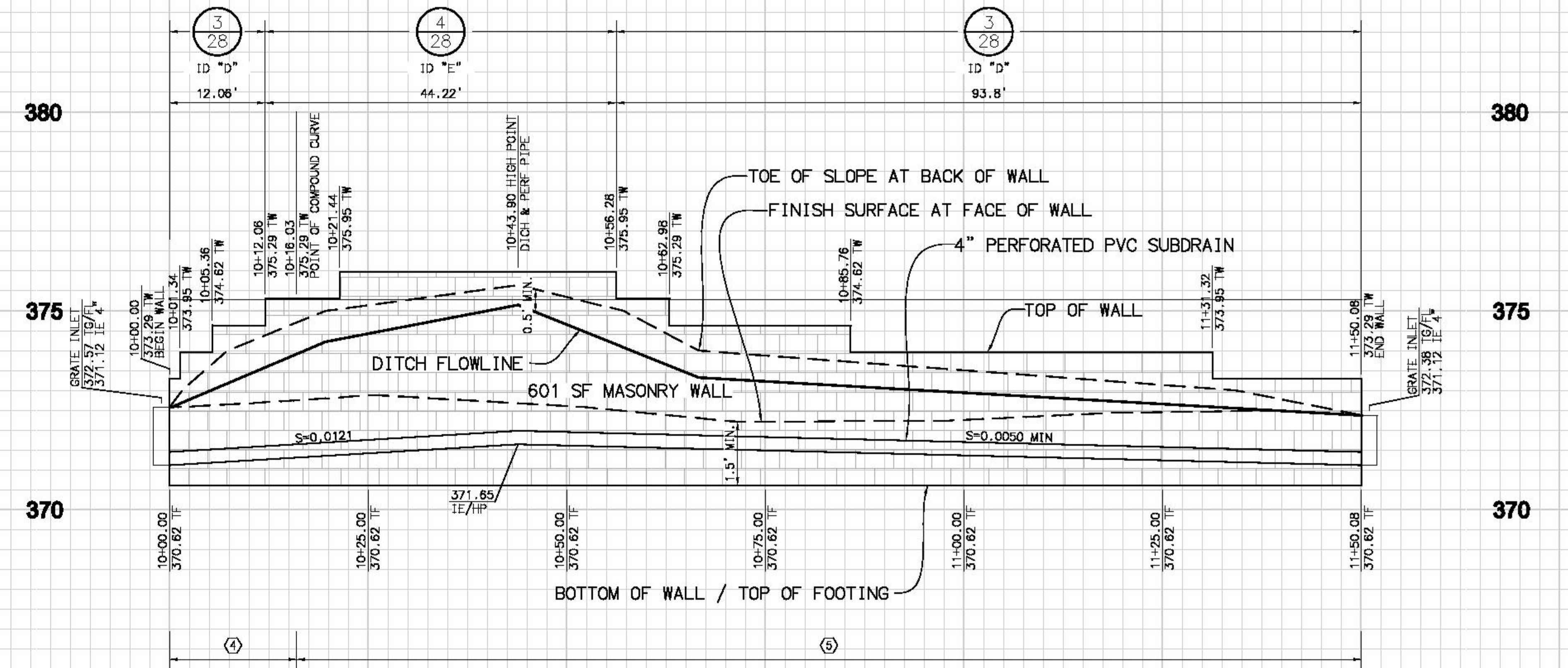

RETAINING WALL PROFILE

PROFILE SCALE  
HORIZ. 1" = 10'  
VERT. 1" = 2'

10+00 10+50 20+00 10+00 10+50 11+00 11+50

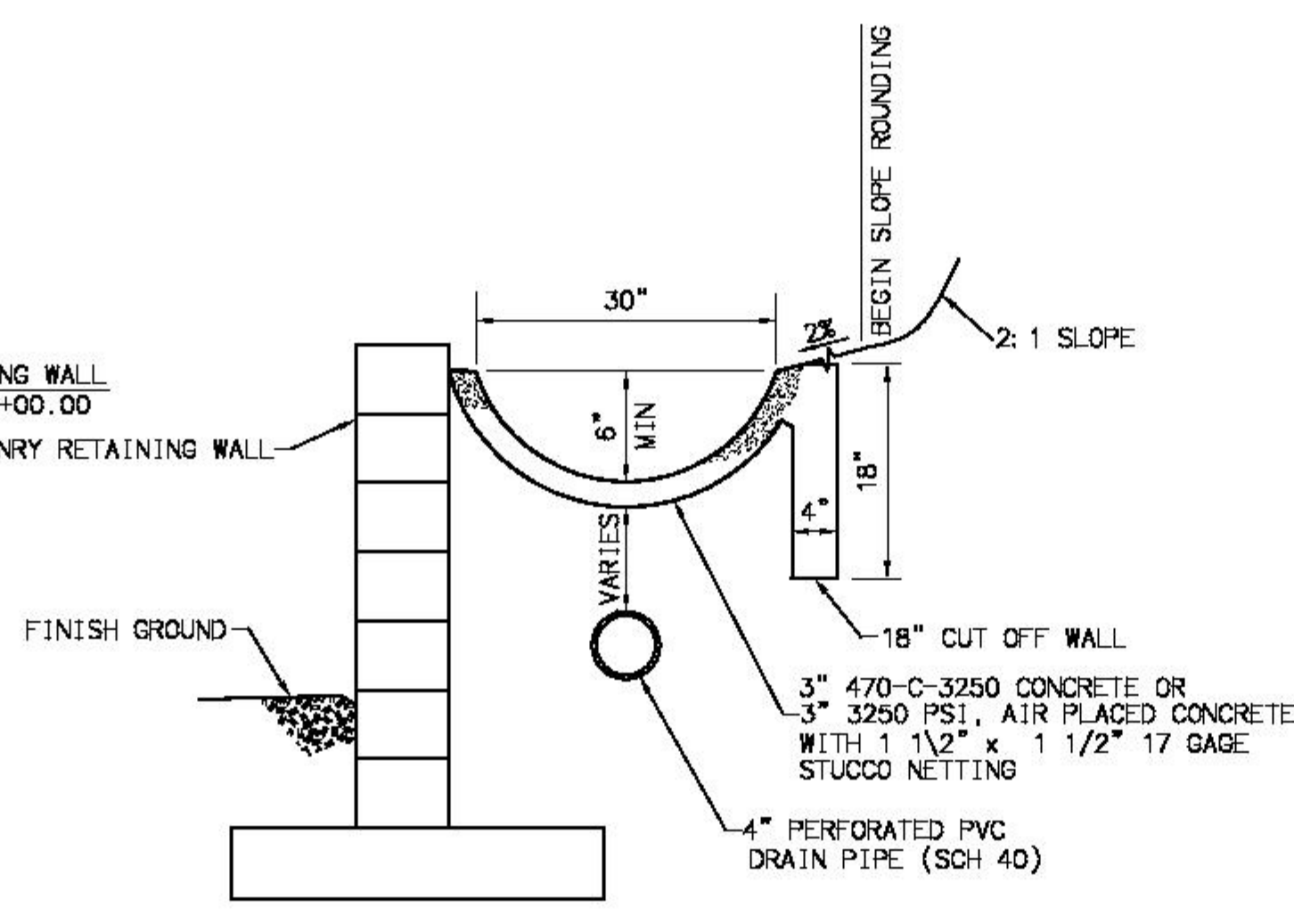
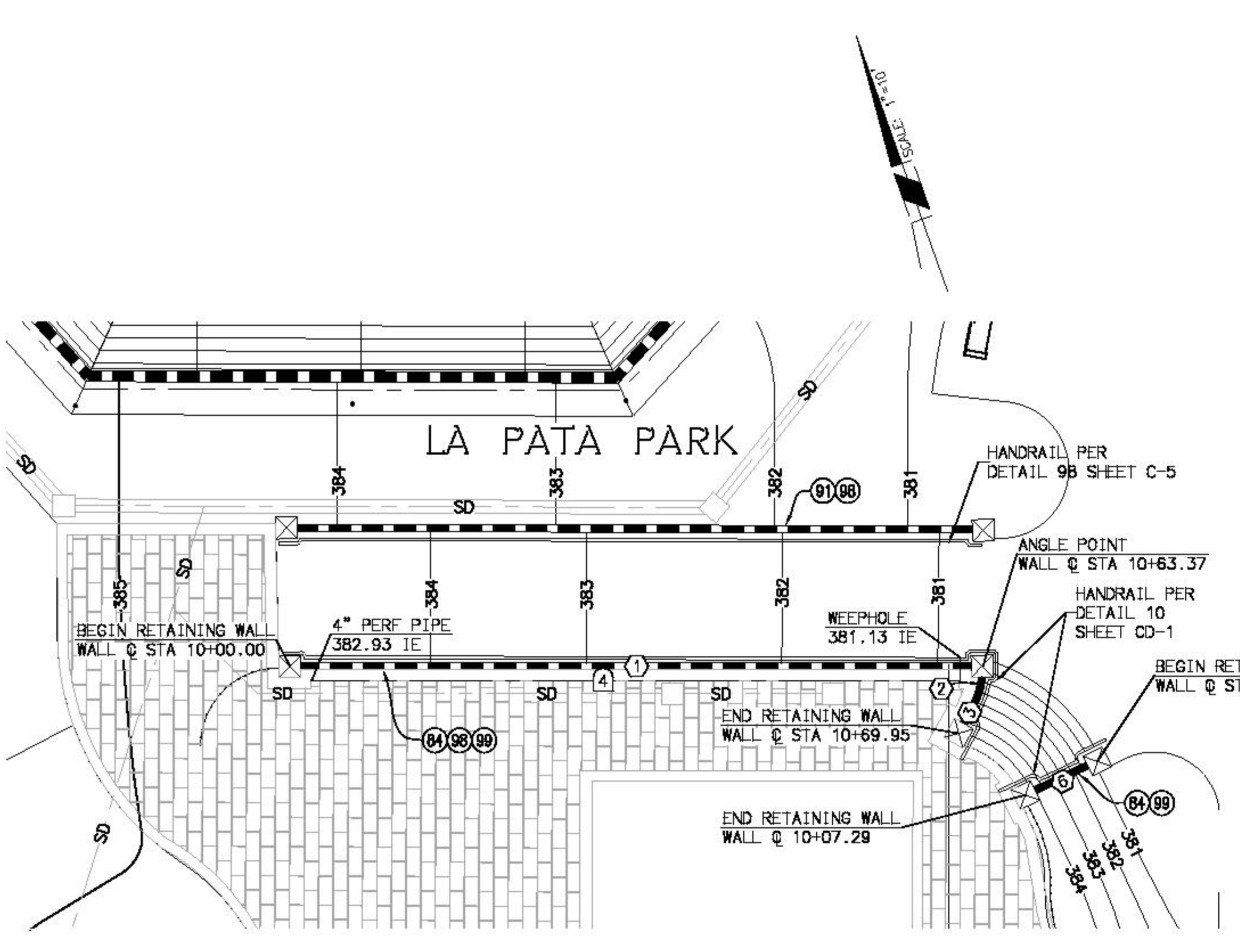

BROW DITCH DETAIL  
NOTES

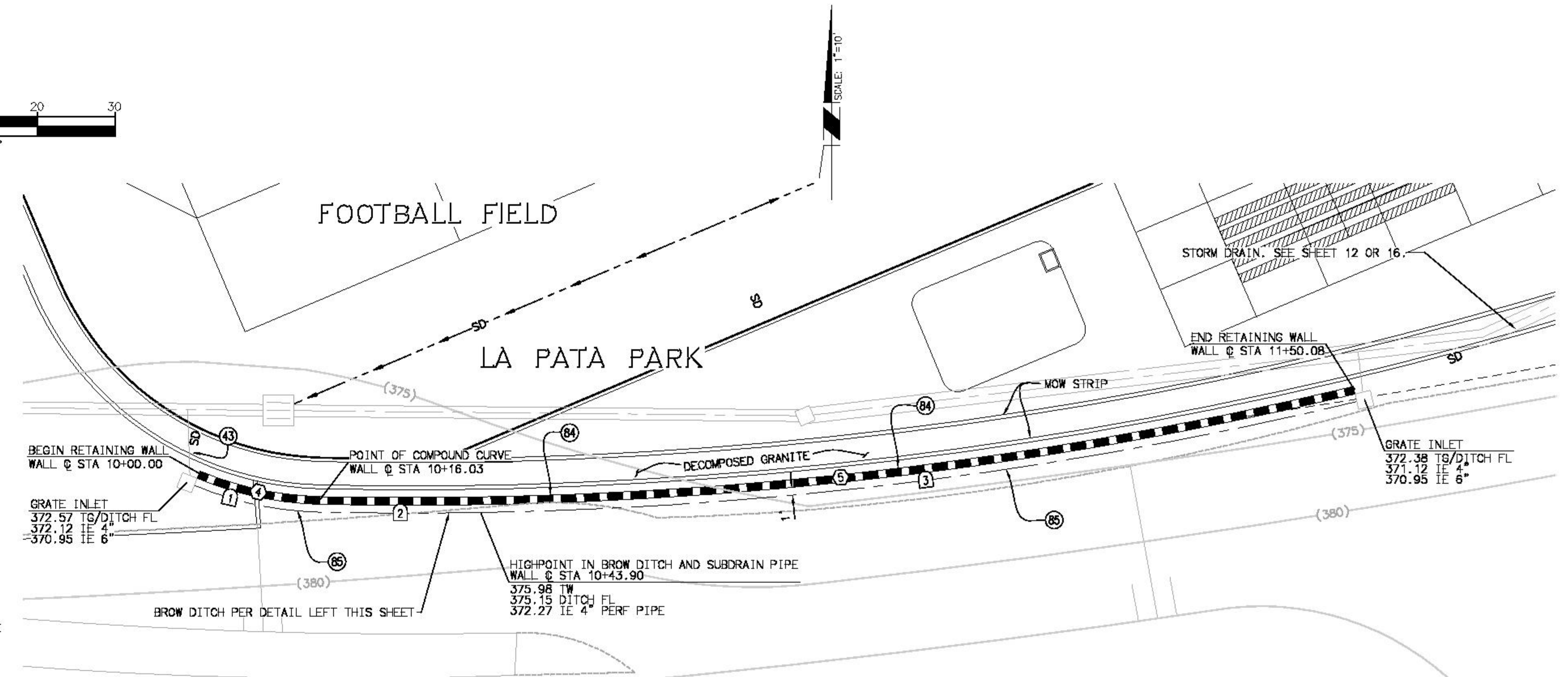

NOTES:  
1. FOR PRECISE GRADING PLAN, SEE SHEET 10.

NO.	BEARING/Delta	RADIUS	LENGTH	NOTE
1	N70°20'23"W	—	63.37'	MASONRY WALL W/PIPE HANDRAIL FOR RAMP PER DETAIL 98 ON SHEET C-5 AND PEDESTRIAN PROTECTIVE RAILING PER DETAIL 99 ON SHEET C-5 AND
2	26°43'57"E	7.76'	3.62'	MASONRY WALL W/PEDESTRIAN PROTECTIVE RAILING PER DETAIL 99 ON SHEET C-5
3	N46°30'19"E	—	2.96'	MASONRY WALL
4	21°26'16"E	42.84'	16.03'	MASONRY WALL
5	14°43'07"E	521.83'	134.05'	MASONRY WALL
6	N84°06'34"E	—	5.29'	MASONRY WALL W/PEDESTRIAN PROTECTIVE RAILING PER DETAIL 99 ON SHEET C-5

NO.	BEARING/Delta	RADIUS	LENGTH	NOTE	SLOPE
1	22°42'17"W	44.49'	17.63'	4" PERFORATED PVC (SCH 40)	0.0121
2	02°15'48"W	523.50'	20.68'	4" PERFORATED PVC (SCH 40)	0.0121
3	12°33'53"W	523.50'	114.80'	4" PERFORATED PVC (SCH 40)	0.0060
4	N70°20'22"W	—	59.30'	4" PERFORATED PVC (SCH 40)	0.0300

NOTES:  
1. FOR PRECISE GRADING PLAN, SEE SHEET 12 OR 20.  
2. FOR STORM DRAIN PLAN, SEE SHEET 15 OR 22.

CONSTRUCTION NOTES

- 1. INSTALL 6" PVC (SCH 40) DRAIN PIPE.
- 2. CONSTRUCT MASONRY RETAINING WALL PER WALL SCHEDULE ON SHEET 32 & DETAILS ON SHEET 30.
- 3. INSTALL 4" PERFORATED PVC (SCH 40) SUBDRAIN PIPE PER DETAIL 1 ON SHEET 30.
- 4. CONSTRUCT FREE-STANDING WALL PER DETAIL 5 ON SHEET S-3.
- 5. INSTALL PIPE HANDRAIL FOR RAMP PER DETAIL 98 ON SHEET C-5.
- 6. INSTALL PEDESTRIAN PROTECTIVE RAILING PIPE GUARDRAIL (POST TYPE) PER DETAIL 99 ON SHEET C-5.

PLANS CHECKED BY:	APPROVED BY:
	AL KING, DIRECTOR OF BEACHES, PARKS, & RECREATION
	WILLIAM E. CAMERON, CITY ENGINEER

REVISIONS			
NO.	DESCRIPTION	REVISED	APPROVED

JOB NO:	55-100467
SCALE:	AS SHOWN
DESIGNED BY:	TB

PLANS PREPARED BY:

**RBF CONSULTING**

5000 AVENIDA ENRIQUEZ, SUITE 200  
CARLSBAD, CALIFORNIA 92008-4096  
760.478.9800 • FAX 760.478.9808 • www.RBF.com

PREPARED UNDER THE SUPERVISION OF:

DATE: \_\_\_\_\_  
R.C.E. # C89815

**CITY OF SAN CLEMENTE**  
DEPARTMENT OF BEACHES, PARKS, & RECREATION

LA PATA PARK

RETAINING WALL PLAN & PROFILE

**C-29**

DRAWING NO.:

SHEET NO.:

**29**

OF 178

H:\DATA\55100467\CADD\LAND\OLVA\GRADINGS\PRECISE\467-29-MR.DWG K:\MAKER 12/8/09 8:49 am